

DL-DWS D-LIGHTZ

Surface Mounted LED Downlight Installation Instruction

Product introduction.....

Surface mounted ceiling light adopts high lumen COB LED. IP54 waterproof structural design, it is an ideal replacement for damp locations. Widely used in general lighting applications such as office, supermarket, shop, school, hotel, etc stairway, lobby, reception, corridors etc.

Installation steps.....

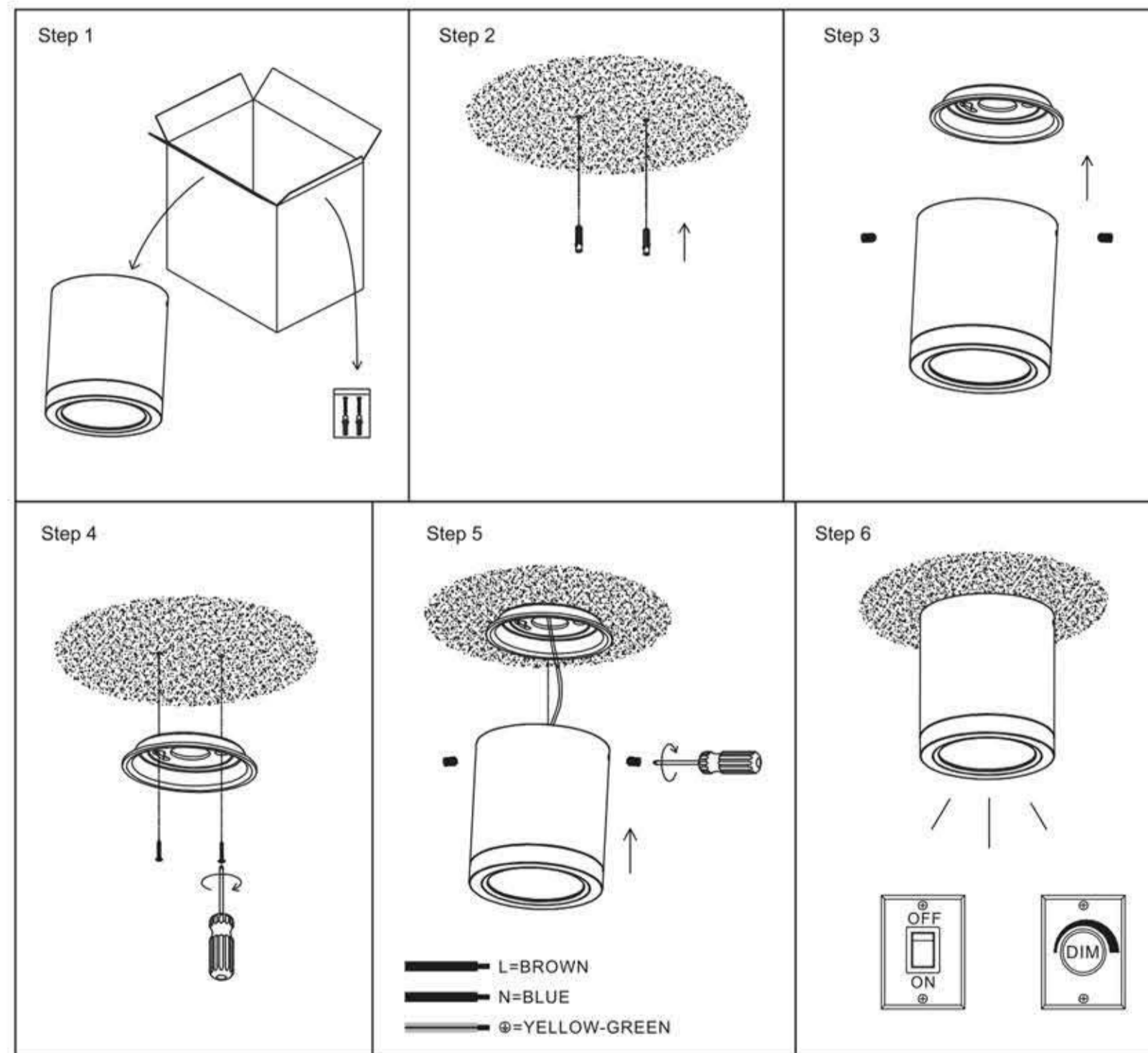

Step 1: Take out the fixtures and fittings from the package box.

Step 2: Take out anchor nuts from the accessory bag, and then screw it in the ceiling (Concrete ceiling only).

Step 3: Open the screw, loosen mounting bracket.

Step 4: Fix the mounting bracket on the ceiling with screw.

Step 5: Open the junction box, connect correctly "L" "N" "G", then mount the lamp to the bracket.

Step 6: Ensure the lighting installation correct, put on the power supply, then the light can be lighted.

Note: applicable for concrete ceiling or wooden ceiling installation only.

Technical parameters.....

Dimension	Power	CCT	PF	Protection grade	Voltage	Dimming	Lifespan
Ø90*100mm	10W	3000K/4000K 5000K/5700K	0.9	IP54	AC100-240V 50/60Hz	NO	40000h
Ø90*100mm	10W	3000K/4000K 5000K/5700K	0.9	IP54	AC200-240V 50Hz	YES	40000h
Ø90*100mm	15W	3000K/4000K 5000K/5700K	0.9	IP54	AC100-240V 50/60Hz	NO	40000h
Ø90*100mm	15W	3000K/4000K 5000K/5700K	0.9	IP54	AC200-240V 50Hz	YES	40000h
Ø120*110mm	18W	3000K/4000K 5000K/5700K	0.9	IP54	AC100-240V 50/60Hz	NO	40000h
Ø120*110mm	18W	3000K/4000K 5000K/5700K	0.9	IP54	AC200-240V 50Hz	YES	40000h
Ø120*110mm	25W	3000K/4000K 5000K/5700K	0.9	IP54	AC100-240V 50/60Hz	NO	40000h
Ø120*110mm	25W	3000K/4000K 5000K/5700K	0.9	IP54	AC200-240V 50Hz	YES	40000h
Ø160*120mm	18W	3000K/4000K 5000K/5700K	0.9	IP54	AC100-240V 50/60Hz	NO	40000h
Ø160*120mm	18W	3000K/4000K 5000K/5700K	0.9	IP54	AC200-240V 50Hz	YES	40000h
Ø160*120mm	35W	3000K/4000K 5000K/5700K	0.9	IP54	AC100-240V 50/60Hz	NO	40000h
Ø160*120mm	35W	3000K/4000K 5000K/5700K	0.9	IP54	AC200-240V 50Hz	YES	40000h

Warning.....

1. Before using this product, please pay attention to high security, make sure the wires are cut off.
2. The power can be on only when all complete installation is ready and ensure all wires correct.
3. Maintenance must be done by professional and technical personnel, non professional personnel do not disassembly the lamp.